



SKmagic Air Purifier

ACL-25C1A

ACL-20C1A



- Please thoroughly read the safety information in this manual before using the product to ensure proper usage.
- Store the manual somewhere safe and accessible so that it can be accessed in the future.
- This product is for domestic use only and cannot be used in other countries with different power supply and voltage requirements.
- The design and appearance of this product are subject to change without prior notice.

(REV.00)

Contents

Safety Information	3
Product Features	7
Before First Use	8
Filter Installation	8
Wheel Cap Removal	9
Product Description	10
Parts	10
Control Panel	11
Display	12
Usage	14
Air Purification Process	14
Filtration	14
Dust Sensor Sensitivity	15
Filter Replacement	17
Cleaning	20
Exterior	20
Front and Rear Covers	20
Sensor	21
Antibacterial Pre-filter	22
Air Outlet	24
Troubleshooting	28
Technical Data	31

Safety Information

- The following instructions are to ensure the safe and proper use of the product in order to prevent unexpected dangers or damages.
- Safety-related precautions are classified according to the expected risk, the extent of the damage, and the urgency of the occurrence of the risk in the event of incorrect use.
- This product is not intended for use by persons (including children) who lack physical, sensory or mental abilities, or who lack experience and knowledge to safely use the product without supervision or instruction.
- Supervise children and do not allow them to play around the product.

WARNING

Failure to follow warning items may result in serious injury or death.

CAUTION

Failure to follow caution items may result in minor injury or product damage.

WARNING

Do not use a damaged power cords or loose outlets.

- Doing so may cause electric shock or fire.
- If the power cord is damaged, contact the place of purchase or service center to exchange it.

Be sure to plug the power cord into a 220-240V, 50Hz/60Hz outlet.

- Failure to do so may result in product failure or damage.

Do not pull on the power cord to move the product.

- Doing so may result in product failure or damage.

Do not touch the power cord with wet hands.

- Doing so may result in electric shock.

Do not damage or deform the power cord by bending it excessively or pressing it with heavy objects.

- Doing so may damage the power cord, resulting in a fire or electric shock.

Do not connect and disconnect the power cord repeatedly.

- Doing so may result in electric shock or fire.

If water has entered the power supply module, unplug the power cable and dry the product completely before use.

- Failure to do so may result in electric shock or fire.

Do not use the product for unintended purposes such as preservation of artwork or academic materials, or for business use.

- Doing so may result in deterioration in the quality of preserved items.

Wipe off any dirt or water on the pins and contacts of the power cord.

- Failure to do so may result in electric shock, fire, or short circuit.

Do not plug multiple electric appliances into one outlet at the same time.

- Doing so may result in power failure or fire.

If the product is not being used for an extended period, disconnect the power cord.

- Doing so can prevent property damage that may occur due to fire.

When opening the filter cover, make sure not to allow your body or any foreign objects to become trapped on the top of the product.

- Doing so may result in injury or product failure.

If the power cord is damaged, do not attempt to change it.

- Doing so may result in electric shock, injury, or fire.

Do not install the product near an electric heater.

- Doing so may result in fire.

Do not place electric appliances on the product, such as heaters and TVs.

- Doing so may result in fire, electric shock, or malfunction.

Do not install the product in humid, dusty, or splashed water.

- Doing so may result in electric shock, injury, or fire.

Do not use flammable gas or substances near the product.

- Doing so may result in product cracking, electric shock, or fire.

Do not install the product on a slope.

- Doing so may result in injury or product failure.
- Doing so may result in water leaks.

Do not insert sharp objects, such as an ice pick, into the sensor.

- Doing so may result in electric shock.

If you hear a strange sound, smell burning, or see smoke coming from the product, immediately unplug the power cord and contact our service center.

- Failure to do so may result in electric shock or damage.

Never immerse the product in water.

- Doing so may result in electric shock.

Do not spray flammable substances, such as pesticides or air fresheners, on the air inlet.

- Doing so may result in fire or deterioration.

Do not open, repair, or modify the product.

- Doing so may result in electric shock, injury, or fire.
- Please contact our service center for repairs.

Do not place water containers, chemicals, food, small metals, or flammable substances on the product.

- If any objects enter into the product, it may result in electric shock, fire, and damage.
- If an object blocks the air outlet, the product may not operate normally, causing a malfunction.

Disconnect the power cord before cleaning the product.

- Failure to do so may result in electric shock or fire.

Do not spray directly with water or clean the product with benzene or thinner.

- Doing so may result in electric shock or fire.

Do not put your fingers or foreign objects into the air inlet or air outlet.

- Doing so may result in injury or product failure.

Do not push or lean on the product.

- Doing so may result in the product falling over and causing injury or product failure.
- There is a risk of water leakage. (Applicable models only)

Do not let children hang or climb on the product.

- Doing so may result in injury and product failure.

Before moving the product, completely empty the water container and water tank. (Applicable models only)

- There is a risk of water leakage.

Do not drink water from the water container. (Applicable models only)

- Doing so may result in health hazards.

 **CAUTION**

Wash the pre-filter regularly with water, and use it only after sufficiently drying it.

Install the product on stable and level ground.

- Vibration may occur when used on uneven, unstable surfaces, such as carpet.
- Using it on a carpet or blanket may cause the sensor to malfunction or result in the product falling over.

Make sure to assemble the parts after cleaning.

- Operating without some components, such as the filter and filter cover, may result in malfunction.

Do not install the product in a location where there are strong odors, smoke, or oil, such as in cafeteria or meat restaurant.

- Doing so may result in fire or deterioration.

Do not install the product in a location exposed to direct sunlight.

- Doing so may result in discoloration or decolorization.

Allow at least 30 centimeters of space between the product and its surroundings and leave at least 1 meter of space above the product.

- Failure to do so may contaminate the ceiling and walls.

Do not apply force or shock to the product.

- Doing so may result in product damage.

To ensure proper air circulation, install the product so nothing obstructs the airflow on the sides, back, or front of the product.

Install the product at least 2 meters away from electronic devices, such as TVs.

- Radio interference may occur.

Replace used filters with new filters when it's time to replace them.

- Failure to do so may result in degraded performance.

Be careful not to expose the product to freezing temperatures.

Do not operate with the filter detached.

- Doing so may reduce the cleaning properties of the filter and result in malfunction.

Only use tap water to clean the pre-filter. (Applicable models only)

- If purified water, alkaline ionized water, mineral water, or well water are used, it may result in excess scaling, mold, and various fungi.
- Adding hot water above 30 °C, aroma oils, chemicals, dirty water, air fresheners, detergents, etc. may cause product deformation and failure.

Do not subject the water bucket to external impacts. (Applicable models only)

- Doing so may result in damage and water leakage.

If there is a possibility of freezing, discard the water in the water bucket and water container. (Applicable models only)

- Failure to do so may result in damage or failure of the water bucket and water container.

Do not operate with the water bucket or water container separately from the product. (Applicable models only)

- Doing so may reduce the cleaning properties of the product and result in malfunction.

When not using the humidification operation, discard the water. (Applicable models only)

- When the product is not in use, discard the water in the water bucket and water container.
- Failure to do so may result in the presence of mold and various fungi.

Product Features



This is a hygienic, **easily detachable** product designed to keep the inside of the product clean.



It features a hygienic, **double antibacterial filtration system** (Antibacterial Pre-filter, Antibacterial Dust Collection Filter) designed to inhibit bacterial propagation in filters.



The **All-in-One Care filter** provides effective solution for eliminating various harmful airborne contaminants.



Auto Mode

Depending on the air quality of the indoor air, the fan speed will be automatically adjusted and the cleaning function will operate. (Operated by selecting Auto mode.)



Concentration Mode

Depending on the air quality of the indoor air, the fan speed will be automatically adjusted and it will create a clean indoor environment at a faster rate than the automatic operation function. (Operated by selecting Concentration mode.)



Sleep Mode

During Sleep mode, the cleaner will operate at the minimum speed and all LEDs, except the Sleep mode LED, will be turned off.

Before First Use

Filter Installation

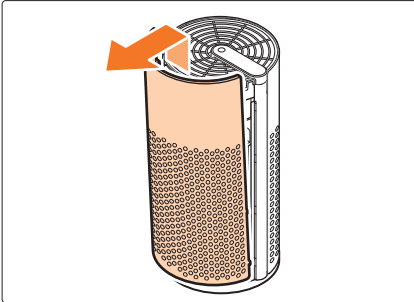

1. Remove the front cover by slightly lifting it upward and pulling it.

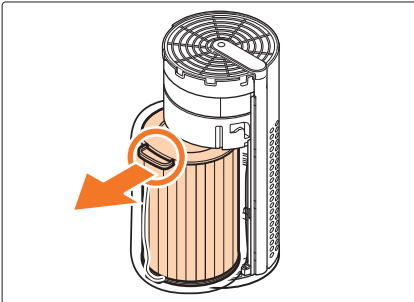

2. Remove the All-in-One Care filter by holding the handle at the top of the filter and pulling it outward.

⚠ CAUTION

- Be sure to hold the product's body tightly to prevent it from falling over.

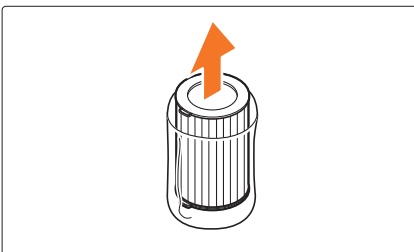

3. Remove the plastic packaging from the new filter that will be installed.

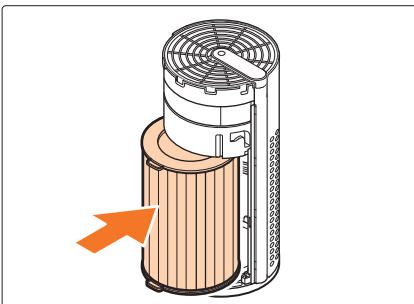

4. Assemble the All-in-One Care filter with the Antibacterial Pre-filter.

⚠ CAUTION

- Be sure to hold the product's body tightly to prevent it from falling over.

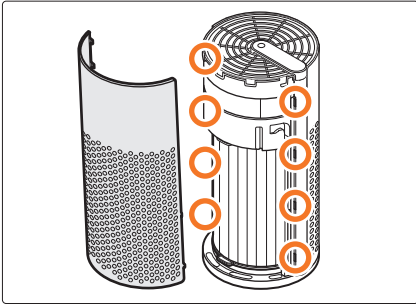

5. Attach the front cover by hooking the cover onto the product and lowering the cover downwards to reattach it.
 - It is easier to assemble by attaching the front cover's lower hooks first.

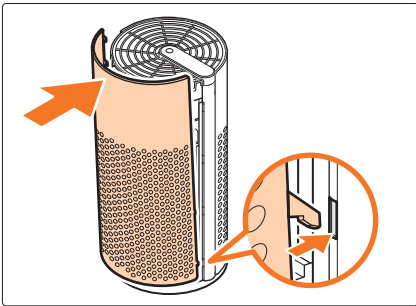

Wheel Cap Removal

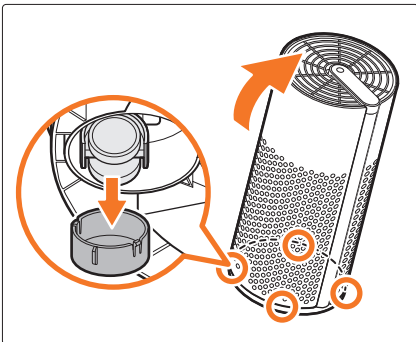

Tilt the product slightly and remove the wheel caps before use.

- There are 4 wheel caps in total.
- The product is equipped with wheels that can move back and forth.

⚠ CAUTION

- When using without removing the wheel cap, vibrations may occur in the product.
- When removing the wheel caps, hold the product firmly so that the product does not slip or fall.
 - If the product falls, it may result in product failure and injury.

Product Description

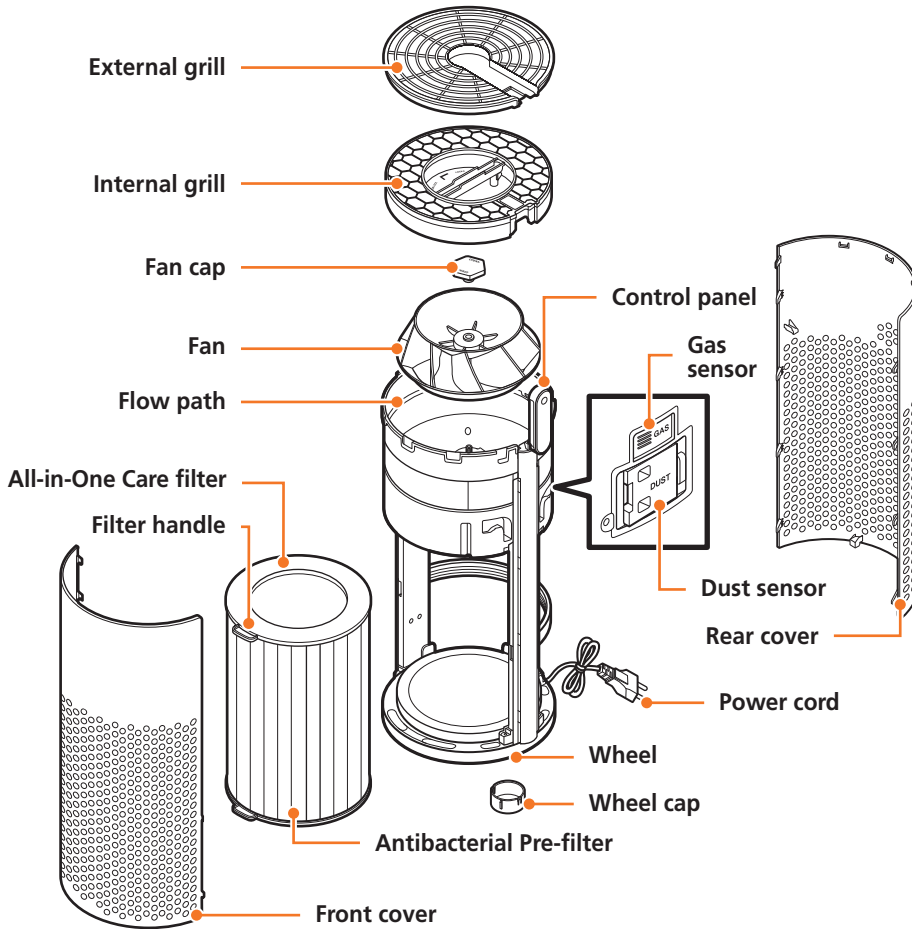

※ The presence of some uneven dot particles on the exterior panel is a natural outcome of the production process, which uses eco-friendly raw materials, and is not a defect.

Parts



User manual

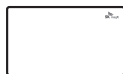

Plastic removal notice



Service card

※ The Service Card is provided to rental customers for our Magic Care Service to fill in the product service history.

Control Panel

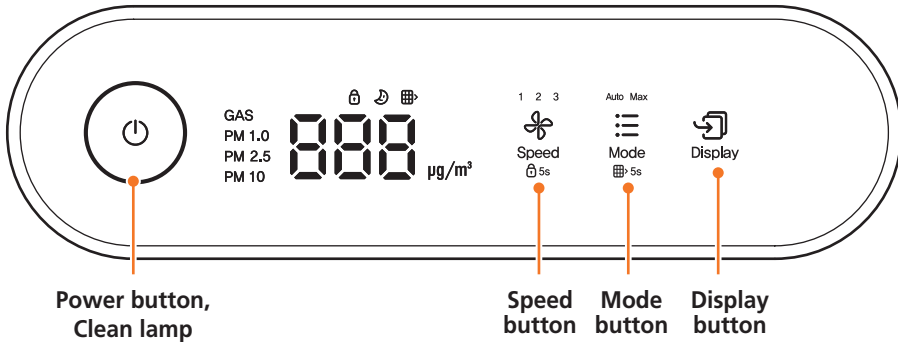

Button	Description
Power, Clean lamp	<ul style="list-style-type: none"> Press this button to operate or stop the product. Connect the power cord, press the [Power] button, and the air cleaner will start operating in the default air cleaning mode at low speed. <ul style="list-style-type: none"> The color of the clean lamp will change depending on the air quality. (Good: Blue, Normal: Green, Bad: Orange, Very bad: Red)
Speed (5 seconds to lock)	<ul style="list-style-type: none"> Press this button to continue operation at the desired speed. Each time this button is pressed, the mode will cycle between low speed, medium speed, high speed, and Sleep mode. Press and hold the [Speed] button for more than 5 seconds to activate the key lock. <ul style="list-style-type: none"> Press and hold the [Speed] button for more than 5 seconds, and the key lock will release and a beep will sound.
Mode (5 seconds to reset the filter)	<ul style="list-style-type: none"> Press this button to select Auto/Concentration mode. To reset the usage hours and restart the timer, press and hold the [Mode] button for more than 5 seconds after replacing the filter. <ul style="list-style-type: none"> Use this only when the filter replacement notification is turned on.
Display	<ul style="list-style-type: none"> Press this button to check the dust concentration for a specific dust particle size. Each time the button is pressed, it will cycle between PM 10, PM 1.0, Screen Off, PM 2.5, and the default setting is PM 2.5. <ul style="list-style-type: none"> When the screen is off, all LEDs, except the Comprehensive Air Quality LED and Wi-Fi LED, will be turned off.

Display

Comprehensive Air Quality Check

- The comprehensive air quality, depending on coarse particles, fine particles, and gas pollution levels, will be displayed in 4 levels: Good, Normal, Bad, and Very bad.
- The color of the clean lamp changes depending on the comprehensive air quality. (Good: Blue, Normal: Green, Bad: Orange, Very Bad: Red)

NOTE

- Coarse particles (PM 10): Dust with a diameter of 10 μm or less
- Fine particles (PM 2.5): Dust with a diameter of 2.5 μm or less
- Ultrafine particles (PM 1.0): Dust with a diameter of 1.0 μm or less

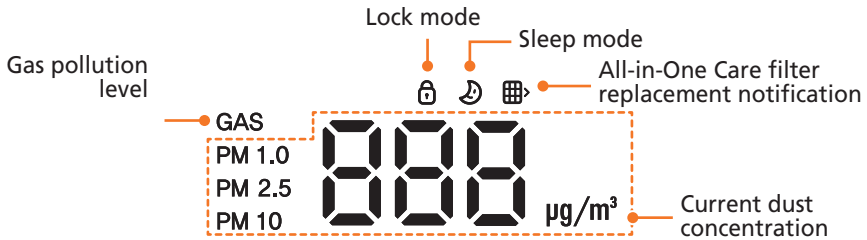

※ The above image may differ from the actual appearance.

Indicator Lamp	Description
Gas pollution level	<ul style="list-style-type: none"> • Turns on when the ambient gas concentration is Normal, Bad, or Very bad. • Turns off when the ambient gas concentration is Good.
Lock function	<ul style="list-style-type: none"> • Displays the button lock status of the product.
Sleep mode	<ul style="list-style-type: none"> • Turns on when Sleep mode is operating.
All-in-One Care filter replacement notification	<ul style="list-style-type: none"> • The All-in-One Care filter replacement notification indicator will turn on depending on the maximum usable period, taking into account the running time of the product. Depending on the usage time and usage environment, the replacement time may vary. • For instructions on how to turn off the All-in-One Care filter replacement notification, refer to "Replacing the Filter." • Filters are consumables, so if contamination is severe or the filter emits an unpleasant odor, even during the warranty period, purchase a new one and replace it.
Current dust concentration	<ul style="list-style-type: none"> • The current dust concentration will be displayed by dust size.

- The clean lamp will turn on when the air cleaner is operating.
- Each time the [Display] button on the upper control panel is pressed, it will cycle between PM 10, PM 1.0, Screen Off, and PM 2.5; the default setting is PM 2.5.
- If different products are used in the same space, differences in the concentration of coarse particles and fine particles may occur due to air circulation.

- There may be differences between coarse particles and fine particles, depending on the usage environment, such as if the product is near a construction site, you are using a vacuum cleaner, or cleaning blankets.
- In environments where yellow dust occurs or outside air is introduced, the color may be consistently displayed as Very bad.



NOTE

- The colors of the comprehensive air quality will be displayed by comprehensively considering coarse particles, fine particles, and gas conditions.
- The comprehensive air quality is displayed based on the worst condition among coarse particles, fine particles, and gases. In other words, if coarse particles and gases have a "Good" condition, but fine particles have a "Bad" condition, the comprehensive air quality will be displayed as "Bad."

Clean Lamp	Blue	Green	Orange	Red
Comprehensive air quality	Good	Normal	Bad	Very bad
Fine particles (PM 2.5, PM 1.0)	Less than 15	16-35	36-75	76 or higher
Coarse particles (PM 10)	Less than 30	31-80	81-150	151 or higher

- The concentration of coarse particles and fine particles may differ from other measuring instruments, other products, and the forecasts from the Ministry of Environment. The particulate matter value published by the Ministry of Environment measures dust concentration via the gravimetric and beta ray absorption methods, but the product measures the quantity of dust and converts it into a mass concentration, so the results may differ from the actual dust concentration.

Check Message Verification

Check Message	Description
	<p>If the front cover is not assembled, a buzzer will sound and the drF notification will appear.</p> <ul style="list-style-type: none"> • Make sure to assemble the front cover.
	<p>If the control panel is not placed on the external grill, a buzzer will sound and the drt notification will appear.</p> <ul style="list-style-type: none"> • Place the control panel on the external grill.
	<p>If the front cover and the control panel are not placed on the external grill, a buzzer will sound and the drA notification will appear.</p> <ul style="list-style-type: none"> • Make sure to assemble the front cover and control unit.

CAUTION

- If a drF, drt, or drA notification appears, the motor will not rotate.

Usage

Air Purification Process

- **Antibacterial Pre-filter:** Removes relatively large household dust particles, hair, and pet hair and has an antibacterial function to prevent the growth of bacteria in the filter.
- **All-in-One Care filter**
 - Removal of hazardous gases: Removes substances that cause everyday odors and haze, such as cigarettes, food, and animal odors, as well as hazardous gases and VOCs that cause sick house syndrome.
 - Removal of fine particles: Removes not only coarse particles that cause allergies from the air, but also fine PM 2.5 particles and yellow dust.
 - Antibacterial function: It inhibits the growth of bacteria, such as mold, from the filter.

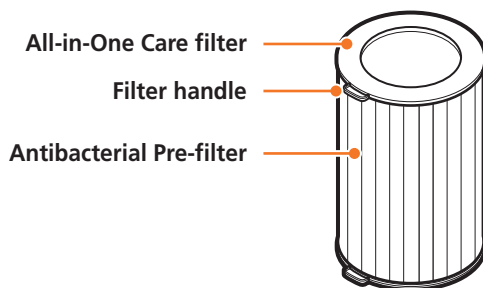

Filtration

1. This product consists of 2 filters that provide the All-in-One air care solution.
2. Using the air cleaner without the filters has no air cleansing effect.
3. When first purchased, new filters may smell. The smell will disappear naturally if used for more than a day, so use it with confidence.
4. If the air cleaner is used in a foul-smelling environment, the life of the All-in-One Care filter will be shortened rapidly. In severe cases, odors may seep into the All-in-One Care filter. If excessive odor occurs, ventilate the area to remove severe odors. It is recommended to use the product to remove the remaining odor after ventilation.
5. Because the All-in-One Care filter is an antibacterial filter that contains copper, it has a coppery color. The filter is not reused or contaminated, so use with confidence.

NOTE

- The Antibacterial Pre-filter can be attached using Velcro. When washing the pre-filter with water, remove it from the circular All-in-One Care filter before cleaning it. After washing it, dry it completely and reattach it using Velcro.
- When washing with water, the Antibacterial Pre-filter may become wrinkled, but this will not adversely affect the performance of the filter.

Dust Sensor Sensitivity

The initial setting of the dust sensor sensitivity is normal.

If there is no change in the comprehensive air quality even after operating the product in a state of high indoor air quality pollution level for about 1 hour or more, or if the indoor air quality pollution level is high but maintains a clean state, the dust sensor sensitivity can be adjusted as follows:

Setting the Dust Sensor Sensitivity

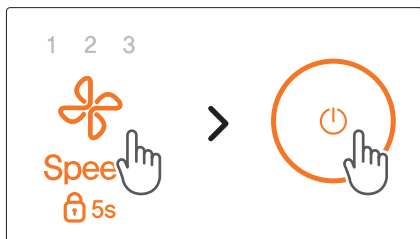

1. While the power is off, press and hold the [Speed] button for 3 seconds, then press the [Speed] button within 2 seconds of hearing the “ding” sound.

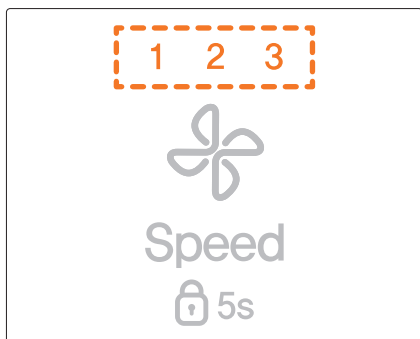

2. Press the [Speed] button to select 1 (Insensitive), 2 (Normal), or 3 (Sensitive) modes for the dust sensor.
 - The initial mode is set to 2 (Normal), and each time the [Speed] button is pressed, it will cycle between 1 (Insensitive), 2 (Normal), and 3 (Sensitive), and the Speed LED will change depending on the mode.
 - **1 (Insensitive)**
When selecting the sensitivity mode, the 1 (Insensitive) Speed LED will turn on, and the dust sensitivity will decrease.
 - **2 (Normal)**
When selecting the sensitivity mode, the 2 (Normal) Speed LED will turn on, and the dust sensitivity will operate in standard mode.
 - **3 (Sensitive)**
When selecting the sensitivity mode, the 3 (Sensitive) Speed LED will turn on, and the dust sensitivity will increase.

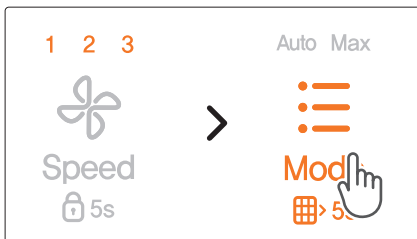

3. After selecting the desired sensitivity mode by pressing the [Speed] button, press the [Mode] button to confirm the setting, and you will hear a “ding” sound.
 - After confirming the settings, turn on the power to use the product normally.

Filter Replacement

- The particulate matter adsorbed on the All-in-One Care filter will not be released outside via the outlet. The change in the color of the surface of the All-in-One Care filter is due to the fact that it has an excellent dust-filtering function, so it can be used safely until replacement.
- It is recommended to replace the Antibacterial Pre-filter **every 4 months to ensure long-lasting antibacterial functionality**.

CAUTION

- When assembling the filter, be sure to check the front (the side with a pull-out handle).
- After replacing the filter, turn on the product and press the [Mode] button for 5 seconds. When the beep sounds, the filter replacement notification will be turned off and the filter life timer will be reset. If the filter is replaced with a new filter and you do not receive a filter replacement notification, perform a filter reset. (The filter replacement notification is a function that applies only to the All-in-One Care filter, and the Antibacterial Pre-filter does not have a separate filter replacement notification lamp.)
- For filters, use genuine SK magic filters to maintain optimum performance.
- Always unplug the power cord before replacing the filter.

Filter Cleaning and Replacement Cycle

Filter	Cleaning	Replacement	Remark
Antibacterial Pre-filter	Once every 2-4 weeks	4 months (recommended)	Washable
All-in-One Care filter	-	12 months	Unwashable

※ The filter replacement cycle may vary depending on the usage environment.
(For how to clean the Antibacterial Pre-filter, refer to "Cleaning" - "Antibacterial Pre-filter.")

Replacing the Antibacterial Pre-filter and All-in-One Care Filter

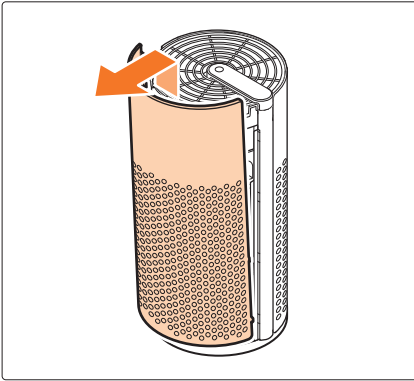

1. Remove the front cover by slightly lifting it upward and pulling it.

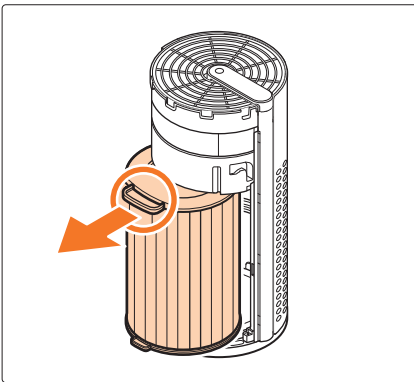

2. Remove the All-in-One Care filter by holding the handle at the top of the filter and pulling it outward.

 **CAUTION**

- Be sure to hold the product's body tightly to prevent it from falling over.



3. Remove the plastic packaging from the new filter.
 - Replace filters according to the replacement time.
 - The Antibacterial Pre-filter can be separated from the All-in-One Care filter by removing the Velcro.

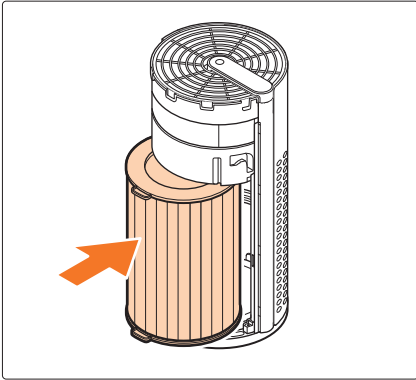

4. Assemble the All-in-One Care filter with the Antibacterial Pre-filter.

⚠ CAUTION

- Be sure to hold the product's body tightly to prevent it from falling over.

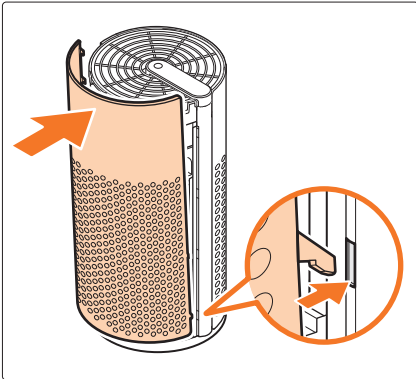

5. Attach the front cover by hooking the cover onto the product and lowering the cover downwards to reattach it.
 - It is easier to assemble by attaching the front cover's lower hooks first.



6. Turn on the product, and press and hold the **[Mode]** button for at least 5 seconds. When the beep sounds, the filter replacement notification will turn off and the filter life timer will be reset.
 - If the filter is replaced with a new filter and you do not receive a filter replacement notification, perform a filter reset.
 - The filter replacement notification is a function that applies only to the All-in-One Care filter, and the Antibacterial Pre-filter does not have a separate filter replacement notification lamp.

Cleaning

CAUTION

- Always unplug the power cord before cleaning.
- Do not use detergents containing organic solvents (solvents, thinners, etc.), bleach, chlorine, or abrasives.
- Do not immerse the product in water or allow the product to get wet.

Exterior (Cleaning: Once every 2-4 weeks)

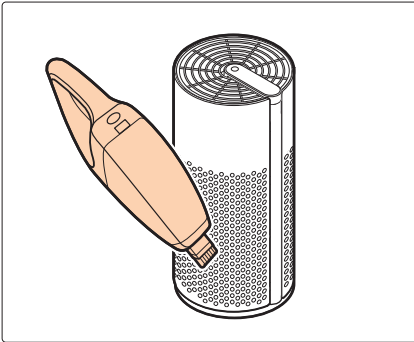

1. Wipe with a soft, dry cloth. Remove dust from the air inlet and the air outlet with a vacuum cleaner.

CAUTION

- If contamination is severe, wipe it with a slightly damp cloth. (Do not use abrasives.)

Front and Rear Covers (Cleaning: Once every 2-4 weeks)

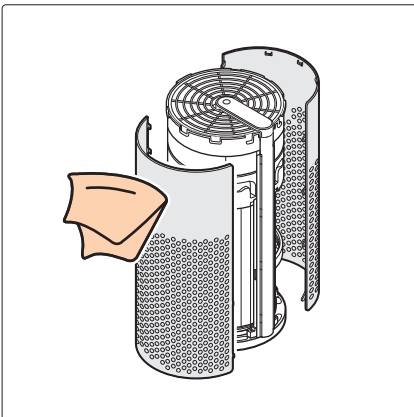

1. After removing the product's front and rear covers, use a soft, dry cloth or soft brush to remove dust from the surface.

CAUTION

- If contamination is severe, wipe it with a slightly damp cloth. (Do not use abrasives.)

Sensor (Cleaning: Once every 4 weeks)

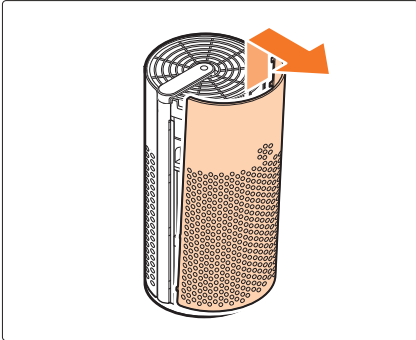

1. Remove the rear cover by slightly lifting it upward and pulling it.

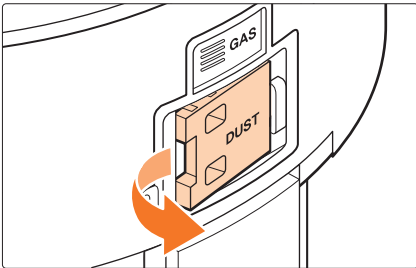

2. Remove the sensor cover.
 - First, clean the dust inlet, dust outlet, and dust sensor detection component with a soft brush or cotton swab.

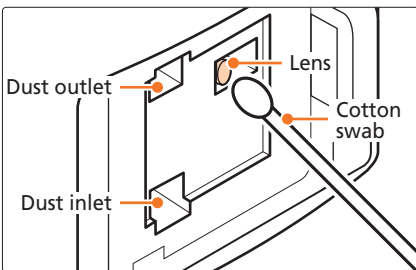

3. Moisten a cotton swab with a little water, wipe the lens, dust inlet, and dust outlet, and then wipe them again with a dry cotton swab to remove moisture.

CAUTION

- If not cleaned periodically, the performance of the dust sensor may deteriorate.
- The cleaning cycle varies depending on the usage environment, so clean more often in dusty environments.

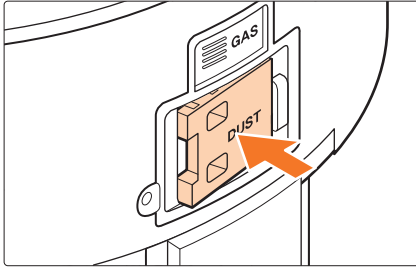

4. Reattach the sensor cover.

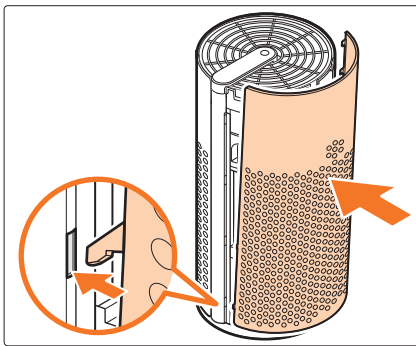

5. Attach the rear cover by hooking the cover onto the product and lowering the cover downwards to reattach it.

- It is easier to assemble by attaching the hook under the rear cover first.

Antibacterial Pre-filter (Cleaning: Once every 2-4 weeks)

CAUTION

- Always unplug the power cord before cleaning.
- The Antibacterial Pre-filter can be cleaned by removing dust or washing it with water.
- If the Antibacterial Pre-filter is not cleaned for a long time, the performance of the product may deteriorate.
- The All-in-One Care filter is not renewed even after cleaning it. Never wash it with water.

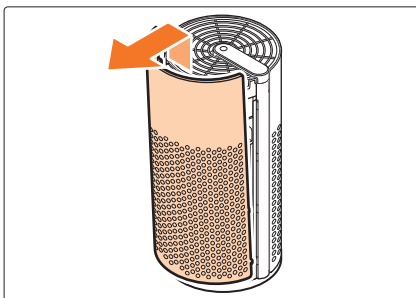

1. Remove the front cover by slightly lifting it upward and pulling it.

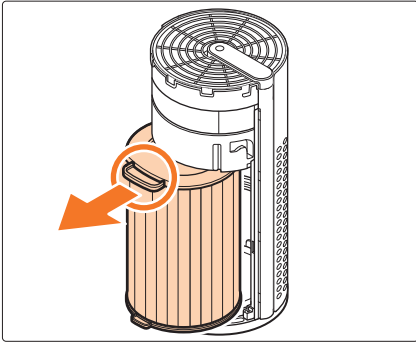

2. Remove the All-in-One Care filter by holding the handle at the top of the filter and pulling it outward.

⚠ CAUTION

- Be sure to hold the product's body tightly to prevent it from falling over.

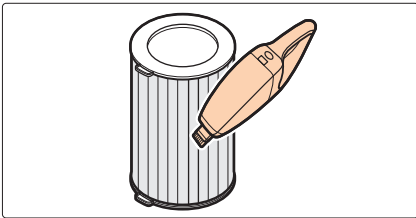

3. Use a vacuum cleaner to remove dust from the Antibacterial Pre-filter surrounding the All-in-One Care filter.
 - If dust is difficult to remove with a vacuum cleaner, remove the Antibacterial Pre-filter from the All-in-One Care filter and wash it gently with water.

- When washing with water, the Antibacterial Pre-filter may become wrinkled, but this will not adversely affect the performance of the filter.

- Note that the shape and antibacterial function of the filter may be damaged when cleaning the Antibacterial Pre-filter with a brush or rubbing it.
- It is recommended to replace the Antibacterial Pre-filter every 4 months to preserve its antibacterial function.

⚠ CAUTION

- Since the antibacterial properties may be lost after washing the Antibacterial Pre-filter with detergent, be careful when using it.

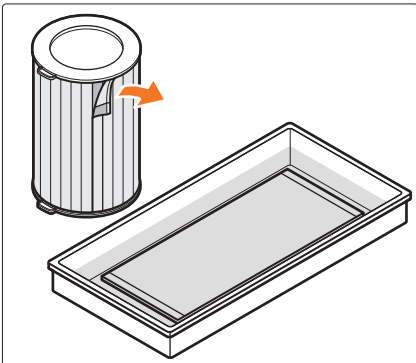

4. When washing the Antibacterial Pre-filter with water, dry it completely and reassemble it with the All-in-One Care filter, and then reinstall the assembled filter in the product.
 - When assembling, assemble in reverse order.

Air Outlet

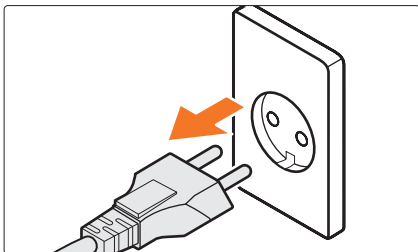

1. Unplug the product.

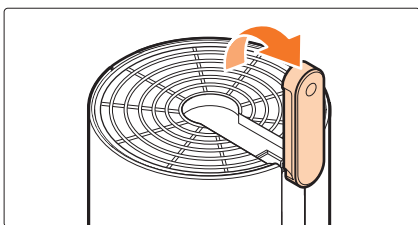

2. Lift the control panel upward.

 **CAUTION**

- Be careful not to bend the control panel by force.

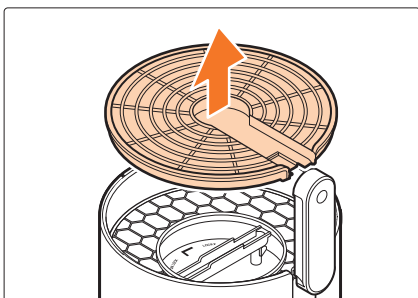

3. Lift the external grill up to remove it from the product.

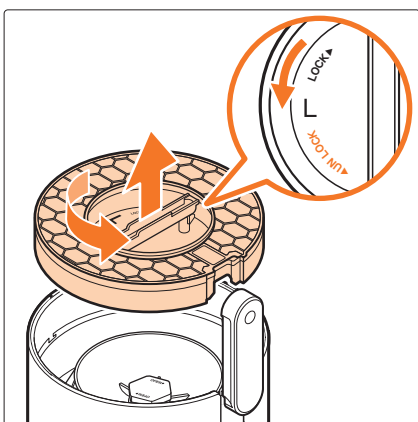

4. Hold the handle in the middle of the internal grill and turn it in the UNLOCK direction (left), then lift it up to remove it.

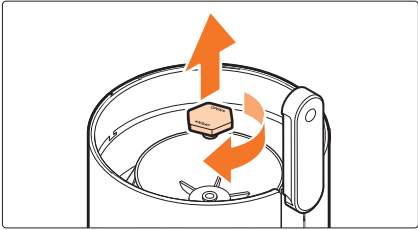

5. Hold the fan in place and turn the fan cap toward OPEN (right) to remove the fan cap.

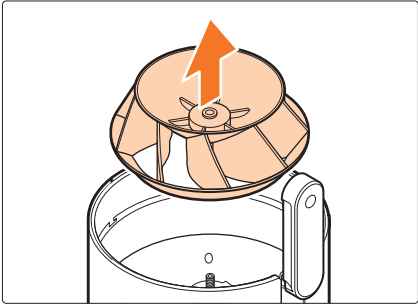

6. Lift the fan upward to remove it from the product.

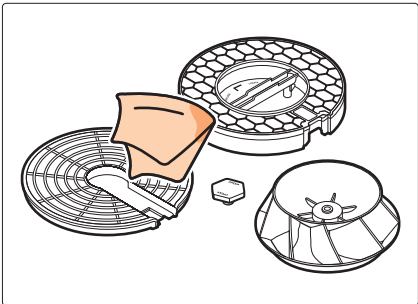

7. Remove dust that has accumulated on the external grill, internal grill, fan cap, and fan with a wet tissue or slightly dampened, soft cloth.
 - If the contamination is severe, remove the dust with water. However, when washing with water, let the parts dry completely before reassembling.

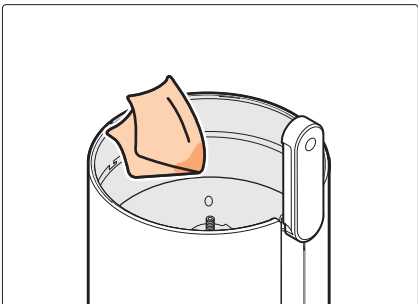

8. Remove dust accumulated in the flow path, only with a wet wipe or a slightly dampened, soft cloth.

⚠ CAUTION

- Washing with water by spraying water directly on the flow path may result in electric shock or product failure.

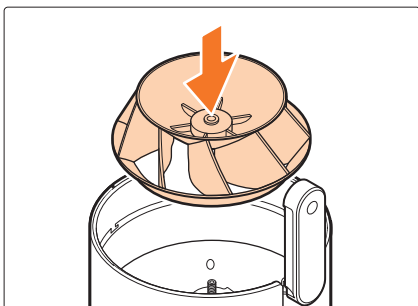

9. Reinsert the fan into the product.

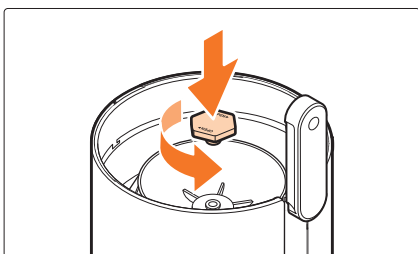

10. Hold the fan in place and turn the fan cap in the direction opposite to OPEN (left) until you feel a snap sound.

⚠ CAUTION

- Faulty assembly of the fan cap may result in injury or product failure.

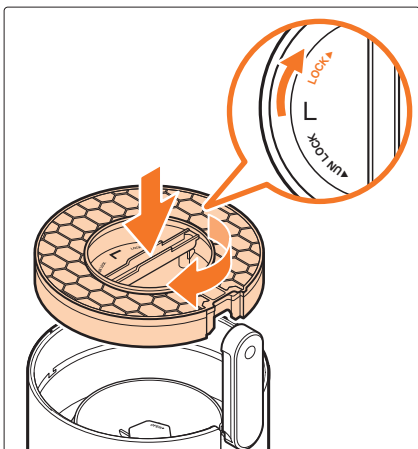

11. Assemble it by holding the handle in the middle of the internal grill and turning it in the LOCK (right) direction.

⚠ CAUTION

- Faulty assembly of the internal grill may result in injury or product failure.
 - To ensure user safety, the fan will not operate in the event of faulty internal grill assembly.

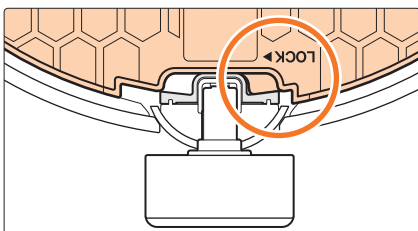

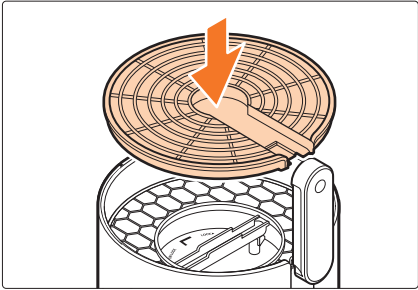

12. Reinsert the external grill in the product.

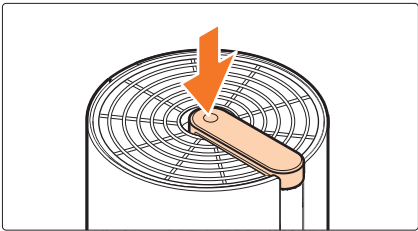

13. Lower the control panel.

⚠ CAUTION

- If the control panel is not in place, the product will not operate.
- Be careful not to allow your fingers or foreign object to become caught in the gaps of the control panel.
 - Failure to do so may result in injury or product failure.

Troubleshooting

Before contacting the customer service center, please check possible causes of malfunction and solution listed below.

Malfunction	Solution
The product is shaking.	<ul style="list-style-type: none">• Check if the product is installed on a flat surface.• If the wheel caps are installed, remove them.• During the initial operation of the product, the product may shake due to the motor drive, but this is a normal part of the motor coming into position.
The LED screen is off. (Applicable models only)	<ul style="list-style-type: none">• Is air coming out?<ul style="list-style-type: none">– Press the [Display] button on the control panel.– If the lock function is activated, deactivate the lock function.• Is it operating in sleep mode?<ul style="list-style-type: none">– Press the [Mode] button.– If the lock function is activated, deactivate the lock function.
Immediately after the power is turned on, the clean lamp blinks sequentially.	<ul style="list-style-type: none">• Does it occur immediately after plugging the power cord into an outlet after turning the power on?<ul style="list-style-type: none">– For the first 30 seconds, it will blink to determine the air quality of the room. After 30 seconds, it will automatically display the ambient air quality.
Air is not coming out.	<ul style="list-style-type: none">• Are the filters packed in plastic?<ul style="list-style-type: none">– Remove the plastic packaging.• Is the power cord connected to an outlet?<ul style="list-style-type: none">– Plug the power cord into a 220-240V, 50Hz/60Hz outlet.• Are all the displays turned off?<ul style="list-style-type: none">– Press the [Power] button to select the desired function.• Is there a power outage?<ul style="list-style-type: none">– Use the product after electricity is restored.• Is the air outlet correctly assembled?<ul style="list-style-type: none">– Check if the internal grill and external grill are assembled correctly.– Check if the control panel is correctly placed on the external grill.

Malfunction	Solution
<p>The speed does not change.</p>	<ul style="list-style-type: none"> • Does it operate manually? <ul style="list-style-type: none"> – Set the desired speed. • Does it operate automatically? <ul style="list-style-type: none"> – If there is no change in the air quality, there will be no change in speed. Check the change in the air quality.
<p>The speed is slower than the initial speed.</p>	<ul style="list-style-type: none"> • Do you need to clean or replace the filter? <ul style="list-style-type: none"> – Check the filter cleaning and replacement cycle, and take any necessary actions. – Contact the service center.
<p>The clean lamp display changes color frequently.</p>	<ul style="list-style-type: none"> • Do you often open or close the door? <ul style="list-style-type: none"> – It may react to opening and closing the door or sudden temperature changes.
<p>The clean lamp does not change from Bad or Good.</p>	<p>When displayed continuously high</p> <ul style="list-style-type: none"> • Are the windows or doors in the room open? <ul style="list-style-type: none"> – If there is a lot of outside air inflow, it may take a while to change to the clean state. • Is the pollution level (dust) sensor dirty? <ul style="list-style-type: none"> – Clean the pollution level detection (dust) sensor. <p>When displayed continuously low</p> <ul style="list-style-type: none"> • Is it installed in a place where contamination is not easily detected? <ul style="list-style-type: none"> – Move the product to a location closer to a pollution source. • Is the air quality becoming cleaner? <ul style="list-style-type: none"> – Near the pollution level detection (dust) sensor, when burning mosquito repellent incense or shaking off torn tissue, if the color of the clean lamp changes, the product is operating normally. (Large dust particles, which are usually visible, may not be detected by the pollution level detection sensor.) – If the pollution level detection is not very sensitive, change the pollution level sensitivity.

Malfunction	Solution
<p>The clean lamp is green, but it is operating at a high speed.</p>	<ul style="list-style-type: none"> • Does it operate manually? <ul style="list-style-type: none"> – During manual operation, it operates at the set speed regardless of the air quality. Change the speed you are using.
<p>The gas pollution level is constantly high.</p>	<ul style="list-style-type: none"> • When using the product for the first time or when using the product after storing it for a long time, the gas level may temporarily be displayed as high. (It takes approximately 48 hours for the product's gas sensor to stabilize. This is not a product defect.) • If the gas pollution level consistently displays as bad, the concentration of hazardous gases, which are undetectable by humans, may be high in the usage area, so open a window to ventilate the area, and then try operating the product again.
<p>The air outlet smells bad.</p>	<ul style="list-style-type: none"> • If using when the smell of cigarettes or grilled meat is strong, odors may be adsorbed onto the filters, and the filters may need to be replaced. <ul style="list-style-type: none"> – Use it with sufficient ventilation. Odors may be adsorbed onto the filters, and the filters may need to be replaced. • Do you need to clean or replace the filter? <ul style="list-style-type: none"> – Check the filter cleaning and replacement cycle in the user manual and take necessary actions, or contact the service center. • Is the contamination of the humidification filter worsening? (Applicable models only) <ul style="list-style-type: none"> – Replace the water in the water container and clean it.

Technical Data

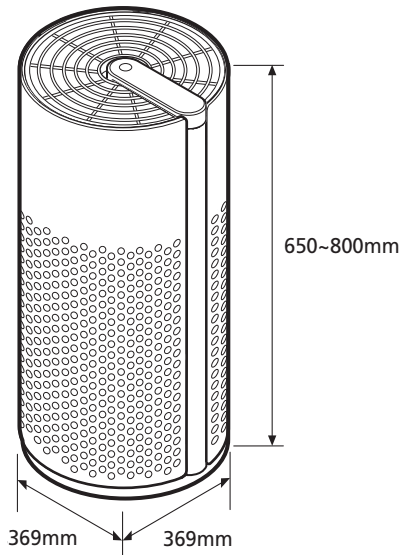

Model Name	ACL-20C1A	ACL-25C1A
Rated Voltage	AC 220-240V, 50Hz/60Hz	
Max. Power Consumption	34W	41W
Insulation Class	Class 2 Device	
Dust Collection Method	Mechanical dust collection method	
Installation Area	For Indoor Use	
Coverage	66.0m ²	82.4m ²
Dimensions	369(W) X 369(D) X 650(H)	369(W) X 369(D) X 800(H)
Weight	10.2kg	11.7kg

- The standard usage area of this product is based on the Korea Air Cleaning Association's Collective Quality Certification System for Indoor Air Cleaners.
- The exterior design and product appearance are subject to change without prior notice.



SKmagic Customer Service Center
1800-18-7878 www.skmagic.com.my